

Please specify the following dimensions when ordering assemblies:

### Loop Sleeves

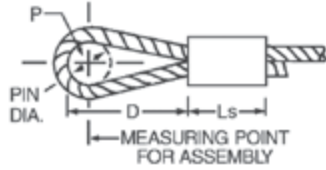

**P** - Pin diameter. This # should be at least 5 times the cable diameter for guaranteed breaking strength.

**D** - Distance from bearing to fitting. This # should be at least 2-1/2 times the Pin diameter.

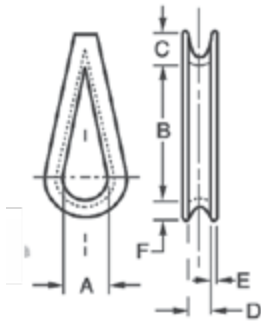

### Thimbles

**A** - Widest diameter inside the thimble.

**B, C, D, E, F** - See diagram.

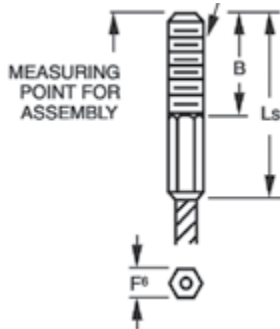

### Threaded Plugs

**B** - Threaded plug length after swaging.

**T** - Size of the thread after swaging.

**L** - Total length after swaging.

**F** - See diagram.

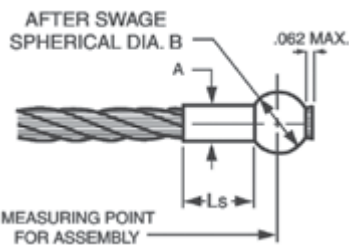
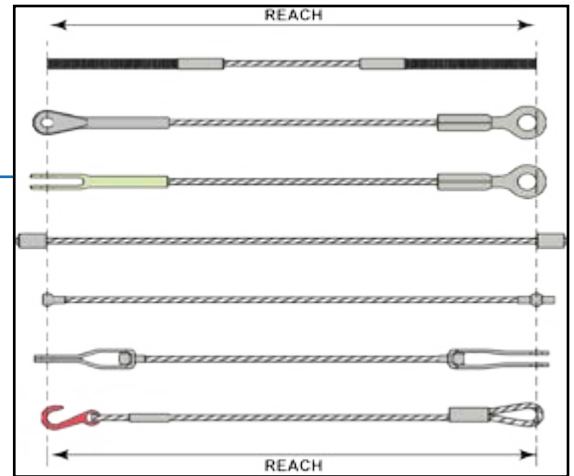

### Ball and Shank

**A** - Length of shank.

**B** - Spherical Diameter of ball after swaging.

**Measuring Point for Assembly** (see diagram).

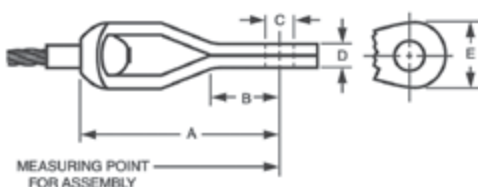

### Strap Eye

**A** - Measuring Point for Assembly (see diagram).

**B, C, D, E** - See diagram.